



Fe²⁶ | IRON RAILING

SIMPLIFIED

+1-352-508-4990



CODE
COMPLIANCE



Intertek
CCRR-0192



IRON MADE. FORTRESS STRONG.

Fortress Fe²⁶ Iron Railing is a pre-welded, easily customized and enhanced version of traditional wrought iron railing that brings unparalleled quality to any patio, deck, balcony or porch. It provides a clean, classic appearance that is versatile for a variety of applications and surfaces. Pre-galvanized steel, zinc phosphate, e-coat and premium powder coating make it the most elegant and durable iron railing system on the market.

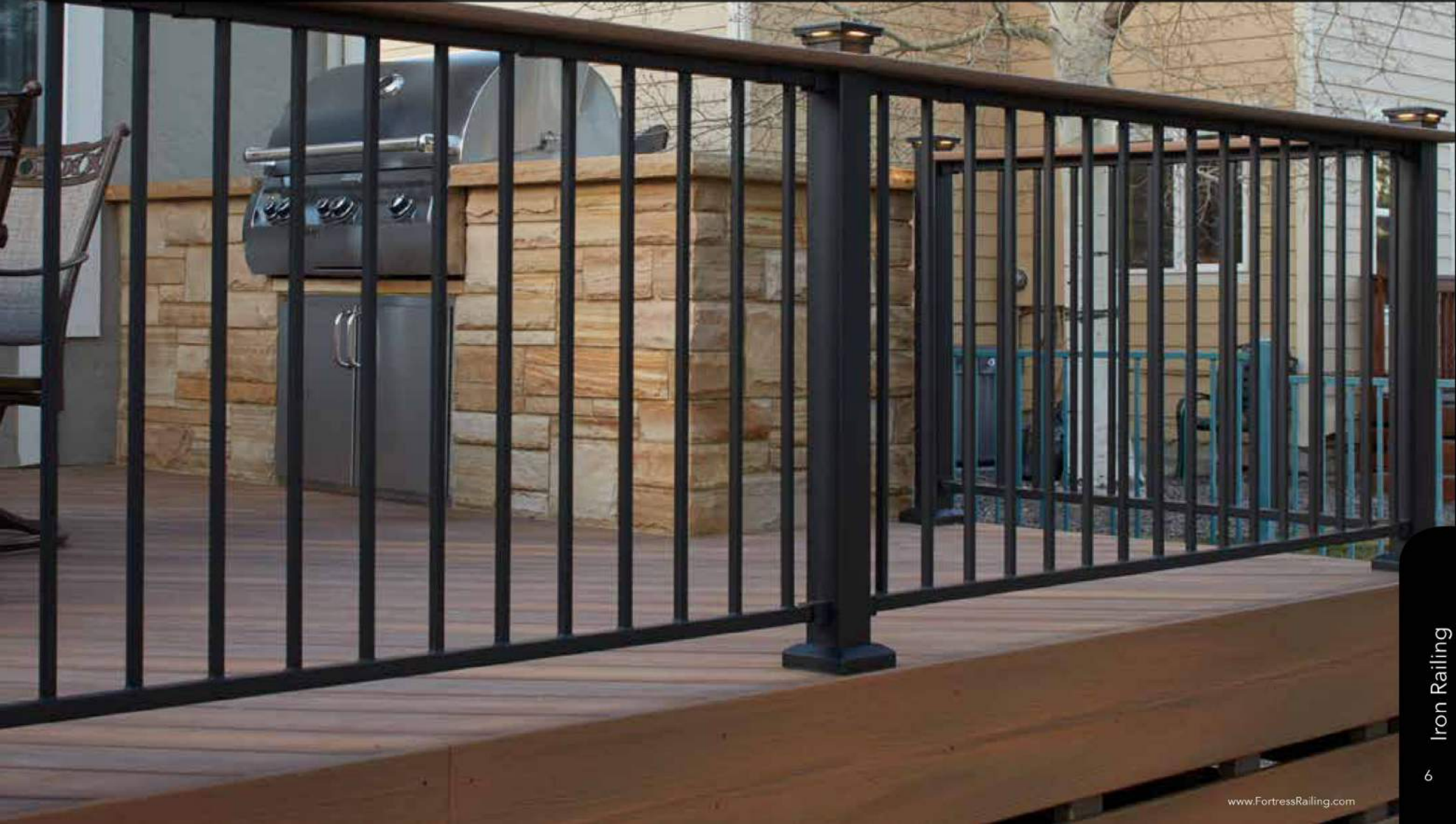



Fe²⁶ | IRON RAILING

SELECTION SIMPLIFIED



All panels can be used with several types of posts such as Metal, Wood, Vinyl or Composite

LEVEL

TRADITIONAL

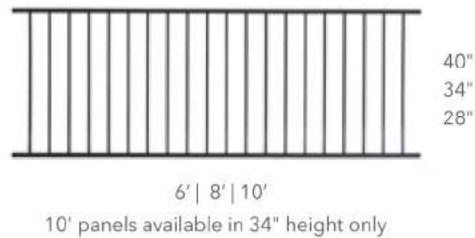

ORNAMENTAL

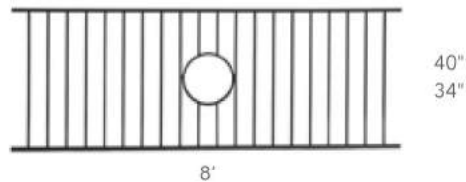

VIENNA

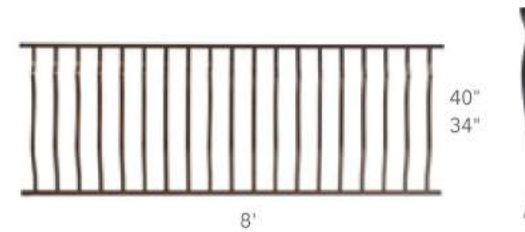

STAIR

TRADITIONAL ADJUSTABLE

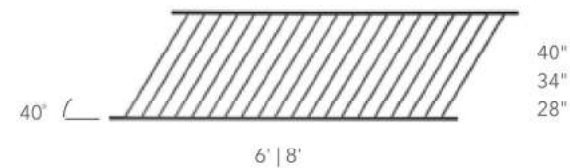

Reference the Fortress Railing Product Grid on page 65 for exact dimensions



I-Support
(Panel support optional)

FEATURES & BENEFITS

- Pre-welded Panels with Patented bracket system
- FortressShield Coated utilizing advanced automotive coating process to resist rust and corrosion
- Many customizing options to choose from
- Use with Wood, Composite, Vinyl or Fortress Iron Posts
- Quick and Easy Installation
- Fortress Fe²⁶ Panels are tested in accordance with AC273 & OBC/NBCC

PREMIUM FINISH

Fortress Fe²⁶ Iron Railing is available in three premium finishes engineered to withstand the elements.



Protected with



Premium Powder Coat
E-Coat
Quality Pre-treatment
Zinc Galvanized

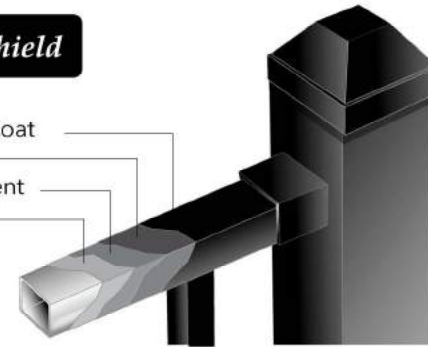

SIMPLE ASSEMBLY

EASY AS 1, 2, 3 **FORTRESS**

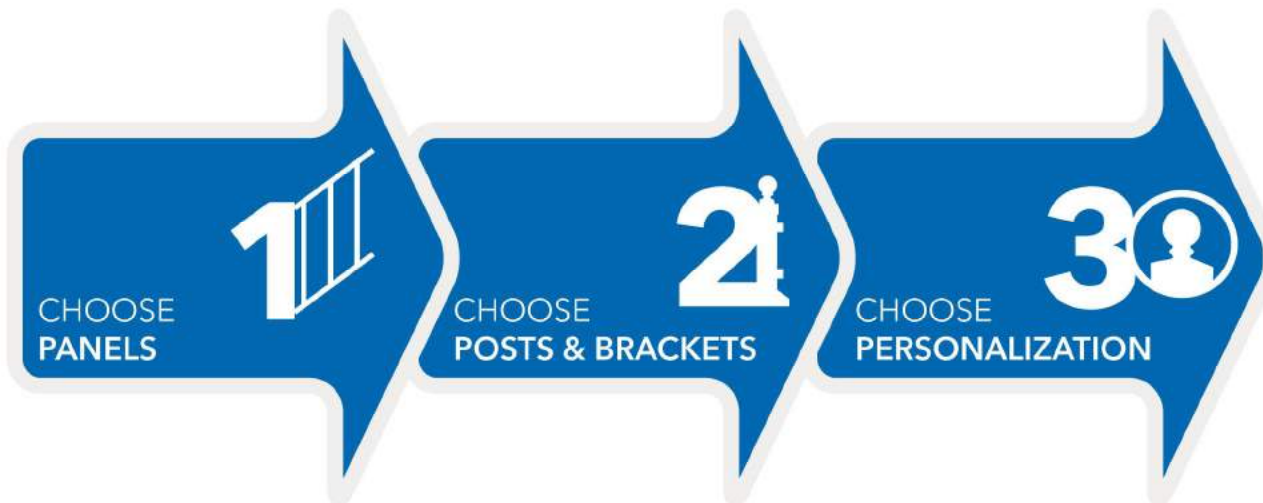

FORTRESS

PANEL ACCESSORIES

ACCENT TOP PANEL

Basket (Gloss Black Only)



8'

Ring Top



8'

Circle Top



8'

3 Rail



8'

ACCENT TOP RAIL

Colonial Round



KNUCKLES



CAP RAIL CLIP



ORNAMENTS



2D Star



3D Star



4CS



Mountains



Elk

(To be used for ornamental panels only)

GATES

TRADITIONAL GATE



34.5"

40"
34"

(Hinges, Locks and Latches are available)

GATE UPRIGHTS (Make a gate)



40"
34"

Maximum Overall width 48"



2 | POSTS & BRACKETS

POSTS

All post base plates are pre-drilled enabling ease of wiring for lighting installations

45.5" | 55"

(Goes with 38" Railing panel or 34" Rail panel when using Accent Top Panels)

39.5" | 49"

(Goes with 34" Railing panel and with 28" Rail panel when using Accent Top Panel)



Base Cover not Required



(Post Base Cover included in Post Box with 39.5" and 45.5" Posts")

BRACKETS

UNIVERSAL BRACKET Hidden Fasteners (Patented)



UB
(Level)



UB-ANG
(Add to Universal Bracket for Stair or Angle/Miter Application)

COLLAR BRACKET Traditional Fasteners



CB
(Level)



CBS-ADJ
(Angle/Miter)



CB-ADJ
(Stair)

PATIO BRACKET



Patio Bracket Standard
(Level)



Patio Bracket ADJ
(Stair or Angle/Miter Applications)

(For on-grade 30" or less above ground)

FASCIA MOUNT BRACKET



STRAIGHT
BRACKET



INSIDE CORNER
BRACKET



OUTSIDE CORNER
BRACKET



POST ACCESSORIES

CAPS (Without Lighting Capability)



Pressed Dome Cap
2" | 3"

Ball Cap
2" | 3"
(Gloss Black only)

CAPS (With Lighting Capability)



Flat Pyramid Cap
(For details on applications visit the
FortressAccents on Page 45)



2" | 3"
Shown with Cap
Light Kit



2" | 3"
Shown with
Glow Ring

POST BASE COVER (Use with Wood, Vinyl or Composite Posts)



3.5" | 4" | 5" | 6"
This is available in ALL finishes of
Gloss Black, Antique Bronze, White,
& Black Sand

ACCENT LIGHTING LED LIGHT MOUNTS

(For details on applications visit the
FortressAccents on Page 45)



HANDRAIL SQUARE (IRON)

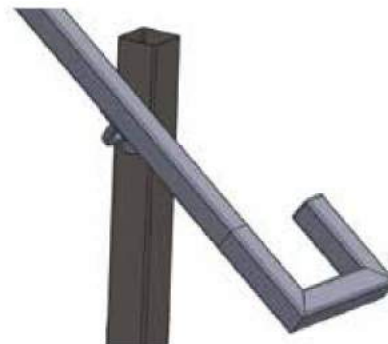

ROUND (ALUMINUM)

